

# HANDLING INFORMATION

## Senso wall unit

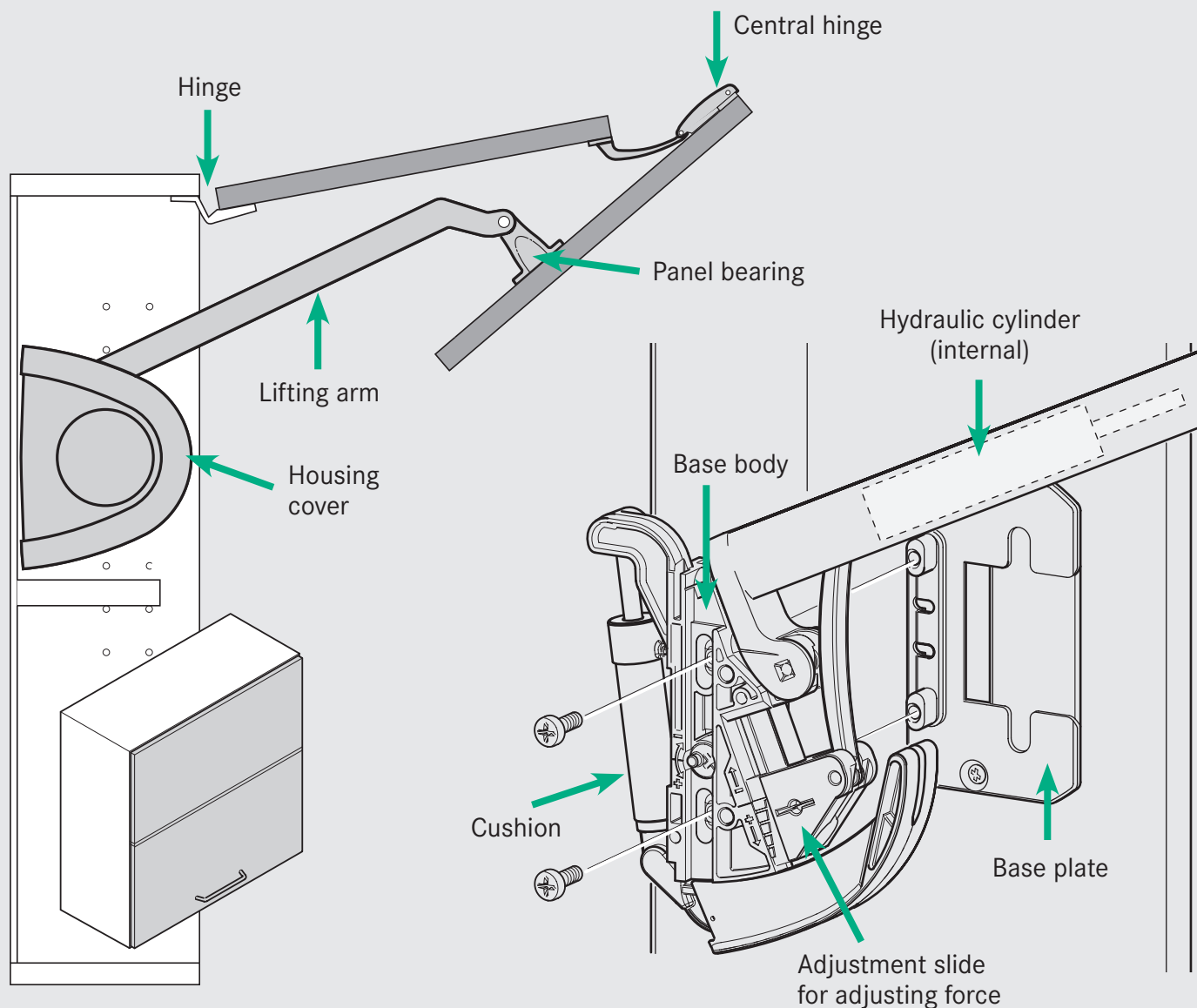

Problem	Possible cause	Possible solution (summary)	Detailed advice
1. Unit panel does not stay in position.	Spring force too low.	Increase/adjust spring force.	1.1
2. Unit panel opens too quickly and springs upwards.	Spring force too high.	Reduce spring force.	2.1
3. Unit door is not aligned when closed.	Base bodies or hinges not correctly adjusted.	Adjust base bodies or hinges.	3.1

## 1. Unit panel does not stay in position

### 1.1 Spring force too low

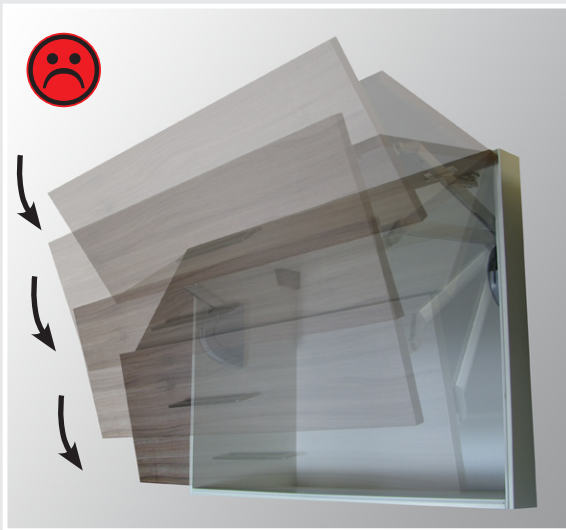

**Do not use a cordless screwdriver!**

Remove the housing cover. Using a socket spanner (4 mm), increase the force by turning the spanner anticlockwise (the adjustment slide moves down). This adjustment procedure must be performed on both lifting arms.

## 2. Unit panel opens too quickly and springs upwards

### 2.1 Spring force too high

Remove the housing cover. Using a socket spanner (4 mm), reduce the force by turning the spanner clockwise (the adjustment slide moves up). This adjustment procedure must be performed on both lifting arms.

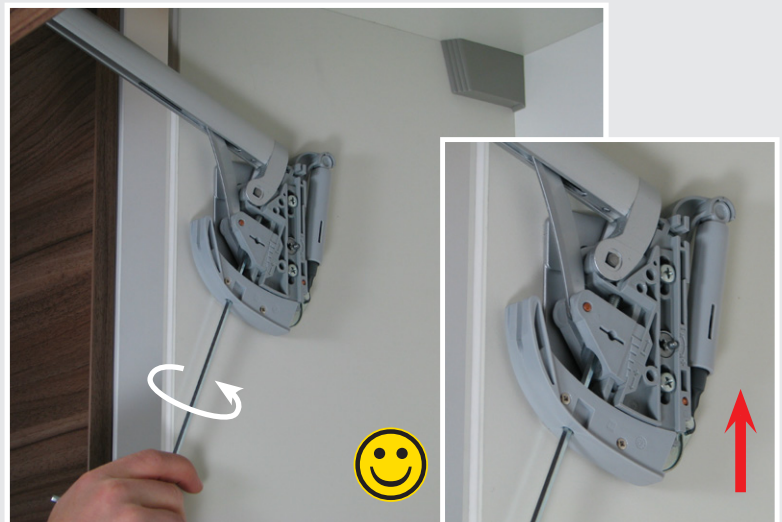

**Do not use a cordless screwdriver!**

### 3. Unit door is not aligned when closed

#### 3.1 Base bodies have not been correctly adjusted

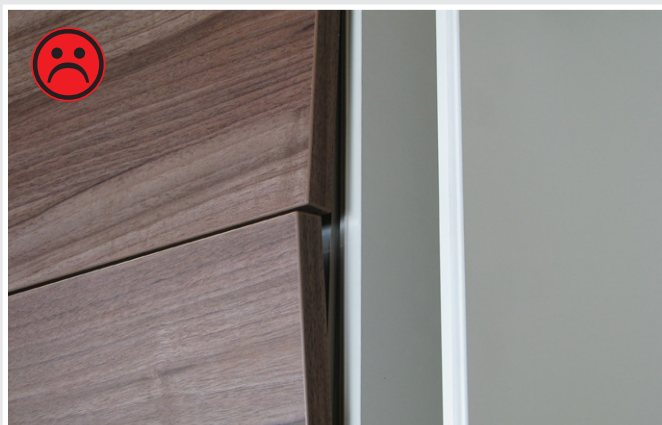

Once the kitchen has been installed (or adjustment work has been performed on the front panels), the front panels may not close cleanly. You can adjust the base body or hinges to improve the closing action.

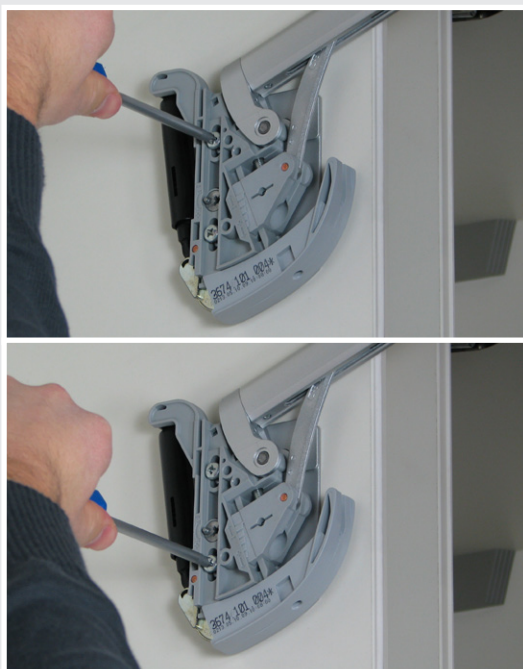

Slacken the two external fixing screws on the base body and adjust the height using the eccentric screw. Once the correct position has been reached, you must retighten the fixing screws. This adjustment procedure must be performed on both lifting arms.



**The two fixing screws must be retightened following adjustment!**